

WEST SUSSEX COUNTY COUNCIL
((ADUR DISTRICT)(PARKING PLACES & TRAFFIC REGULATION)
(CONSOLIDATION) ORDER 2009)
(ADUR DISTRICT: VARIOUS ROADS)(SCHOOL KEEP CLEAR AMENDMENT)
ORDER 2020

LANCING, SHOREHAM/SOUTHWICK, AND SOMPTING: LOCATIONS OF WAITING RESTICTIONS



West Sussex County Council
Highways & Transport
The Grange
Tower Street
Chichester
West Sussex
PO19 1RH

WEST SUSSEX COUNTY COUNCIL
((ADUR DISTRICT)(PARKING PLACES & TRAFFIC REGULATION)
(CONSOLIDATION) ORDER 2009)
(ADUR DISTRICT: VARIOUS ROADS)(SCHOOL KEEP CLEAR AMENDMENT)
ORDER 2020
LOCATION OF WAITING RESTRICTIONS



Reproduced from or based upon 2017 Ordnance Survey mapping with permission of the Controller of HMSO (c) Crown Copyright reserved.
Unauthorised reproduction infringes Crown copyright and may lead to prosecution or civil proceedings
West Sussex County Council Licence No. 100023447

SCALE: 1:45,000
DATE: 12.03.2020

Key for Waiting Restrictions

All areas over which the provision of the orders apply are defined by the shaded areas as shown on the following plans plus a contiguous area not indicated on the plans of verge and/or footway between the carriageway edge and the highway boundary. The plans in this schedule are based upon grid references of the Ordnance Survey National Grid defined by the OSGB 36 triangulation.

Prohibition of waiting

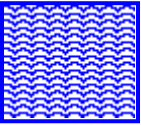
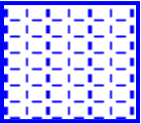
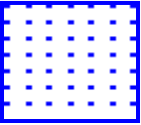
101		check	No waiting at any time
105		smallwave2	No waiting 8.00am-6.00pm any day
107		pat020	No waiting 8.00am-6.00pm Mon-Sat
112		dot5	No waiting 8.00am-6.00pm Mon-Fri

Prohibition of loading

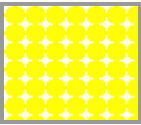
218		circle2	No waiting, loading and unloading 8.00am-5.00pm Mon-Fri
-----	---	---------	---



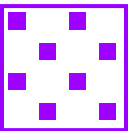

Free Limited Waiting

716		shd62	Waiting limited to 1hr No return within 1hr 8.00am-6.00pm Mon-Sat
-----	---	-------	---

Specified Vehicles

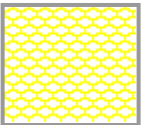
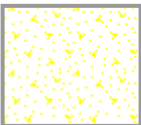
830		check	Disabled persons vehicles at any time
-----	---	-------	---------------------------------------

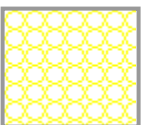
Clearways

1100		usgs503	School Keep Clear-No stopping at any time
1105		usgs723	School Keep Clear No stopping 8.00am-6.00pm any day
1106		rice1	School Keep Clear No stopping 8.00am-6.00pm Mon-Fri
1108		circle1	School Keep Clear No stopping 8.30am-9.15am and 2.45pm-4.00pm Mon-Fri except bank and public holidays 01Sep-31Jul
1110		usgs677	School Keep Clear No stopping 8.00am-5.00pm Mon-Fri

WEST SUSSEX COUNTY COUNCIL
((ADUR DISTRICT) (PARKING PLACES & TRAFFIC REGULATION)
(CONSOLIDATION) ORDER 2009)

(ADUR DISTRICT: VARIOUS ROADS) (SCHOOL KEEP CLEAR AMENDMENT)
ORDER 2020

West Sussex County Council in exercise of their powers under Sections 1 (1) 2 (1) and (2), 4 (2), 45, 46, 49 and 53 and Part IV of Schedule 9 of the Road Traffic Regulation Act 1984 ("the Act") as amended and of all other enabling powers and after consultation with the Chief Officer of Police in accordance with Part III of Schedule 9 to the Act hereby make the following Order:-

1. This Order shall come into operation on the Twelfth day of March 2020 and may be cited as "West Sussex County Council ((Adur District) (Parking Places & Traffic Regulation) (Consolidation) Order 2009) (Adur District: Various Roads) (School Keep Clear Amendment) Order 2020".
2. The "West Sussex County Council (Adur District) (Parking Places & Traffic Regulation) (Consolidation) Order 2009" is hereby amended by the replacement of the plans specified in the First Schedule to this Order, with the plans specified in the Second Schedule, attached hereto.
3. The "West Sussex County Council (Adur District) (Parking Places & Traffic Regulation) (Consolidation) Order 2009" is hereby amended by the insertion of the plans specified in the Third Schedule to this Order, attached hereto.

FIRST SCHEDULE
Plans to be Replaced

TQ1605SES (Issue Number 1)
 TQ1804SEN (Issue Number 3)
 TQ1804SES (Issue Number 2)
 TQ1805NWN (Issue Number 1)
 TQ1904SWN (Issue Number 2)
 TQ1904SWS (Issue Number 2)
 TQ2105NEN (Issue Number 2)
 TQ2105SWN (Issue Number 4)
 TQ2204NWN (Issue Number 1)
 TQ2204NWS (Issue Number 3)
 TQ2205NWN (Issue Number 2)
 TQ2205NWS (Issue Number 3)
 TQ2305NES (Issue Number 1)
 TQ2305NWS (Issue Number 2)
 TQ2305SES (Issue Number 2)
 TQ2305SWN (Issue Number 2)
 TQ2405NES (Issue Number 1)
 TQ1705SES (Issue Number 1)



SECOND SCHEDULE
Replacement Plans

TQ1605SES (Issue Number 2)
TQ1804SEN (Issue Number 4)
TQ1804SES (Issue Number 3)
TQ1805NWN (Issue Number 2)
TQ1904SWN (Issue Number 3)
TQ1904SWS (Issue Number 3)
TQ2105NEN (Issue Number 3)
TQ2105SWN (Issue Number 5)
TQ2204NWN (Issue Number 2)
TQ2204NWS (Issue Number 3) 4
TQ2205NWN (Issue Number 3) 3
TQ2205NWS (Issue Number 3) 4
TQ2305NES (Issue number 2)
TQ2305NWS (Issue Number 3)
TQ2305SES (Issue Number 3)
TQ2305SWN (Issue Number 3)
TQ2405NES (Issue Number 2)
TQ1705SES (Issue Number 2) MM

THIRD SCHEDULE
Plans to be Inserted

~~TQ1705SES (Issue Number 1)~~
TQ1805SWS (Issue Number 1)
TQ2306SEN (Issue Number 1)
TQ1604NEN (Issue Number 1) MM

THE Common Seal of THE)
WEST SUSSEX COUNTY COUNCIL)
was hereto affixed the)
day of TWELFTH)
MARCH 2020)

Trueth)
Authorized Signatory)
ADR8008-MM)



04/08 DELEGATED AUTHORITY

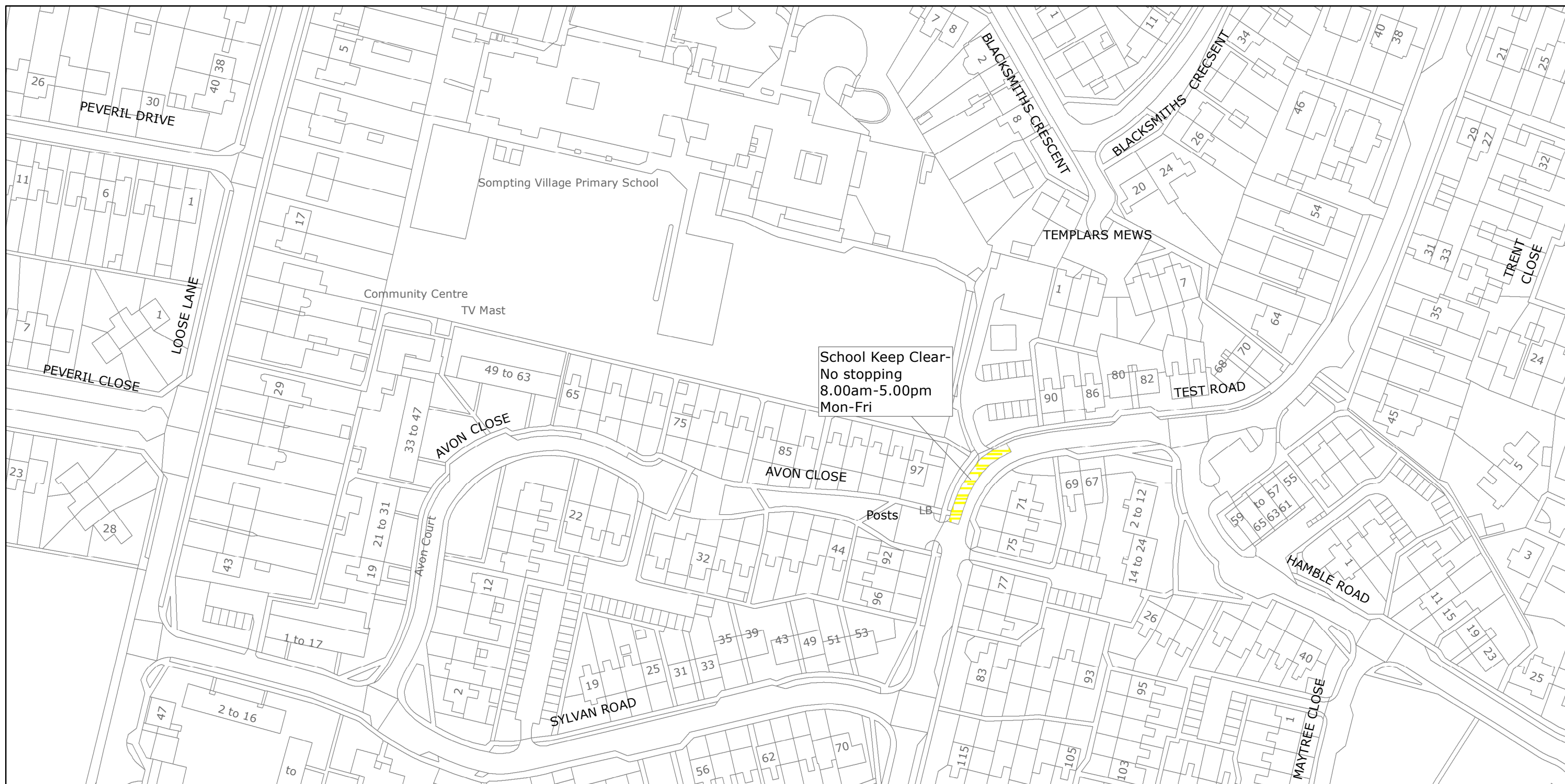

West Sussex County Council
Highways & Transport
The Grange
Tower Street
Chichester
West Sussex
PO19 1RH

ADUR DISTRICT: SOMPTING
WAITING RESTRICTIONS

Reproduced from or based upon 2020 Ordnance Survey mapping with permission of the Controller of HMSO (c) Crown Copyright reserved.
Unauthorised reproduction infringes Crown copyright and may lead to prosecution or civil proceedings West Sussex County Council Licence No. 100018485

TILE REF NO:
TQ1604NEN

SHEET ISSUE NO 1
SHEET ACTIVE FROM - 12/03/2020



SCALE:
1:1250
at A3 size

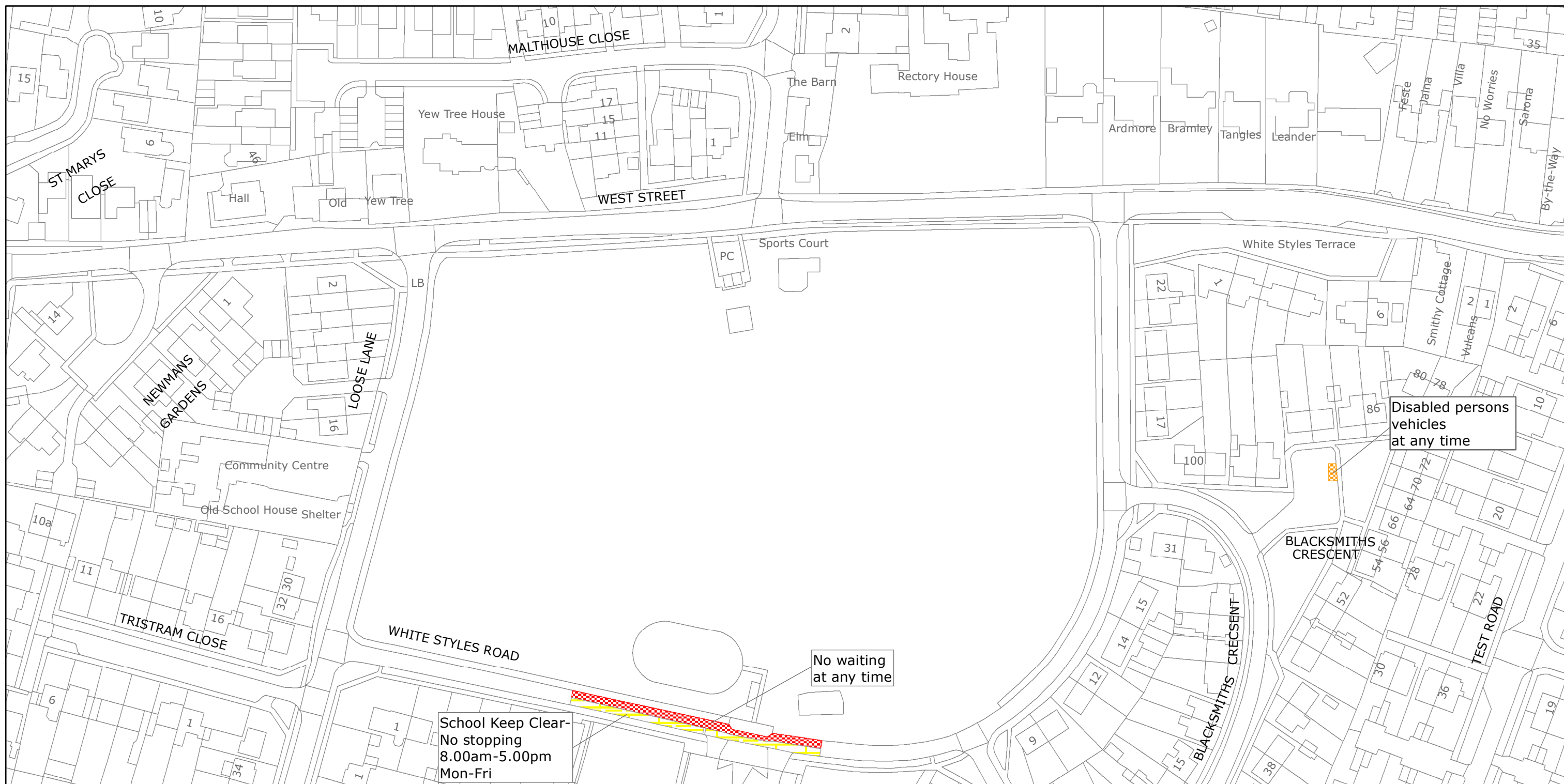

West Sussex County Council
Highways & Transport
The Grange
Tower Street
Chichester
West Sussex
PO19 1RH

ADUR DISTRICT: SOMPTING
WAITING RESTRICTIONS

Reproduced from or based upon 2020 Ordnance Survey mapping with permission of the Controller of HMSO (c) Crown Copyright reserved.
Unauthorised reproduction infringes Crown copyright and may lead to prosecution or civil proceedings West Sussex County Council Licence No. 100018485

TILE REF NO:
TQ1605SES

SHEET ISSUE NO 2
SHEET ACTIVE FROM - 12/03/2020



SCALE:
1:1250
at A3 size

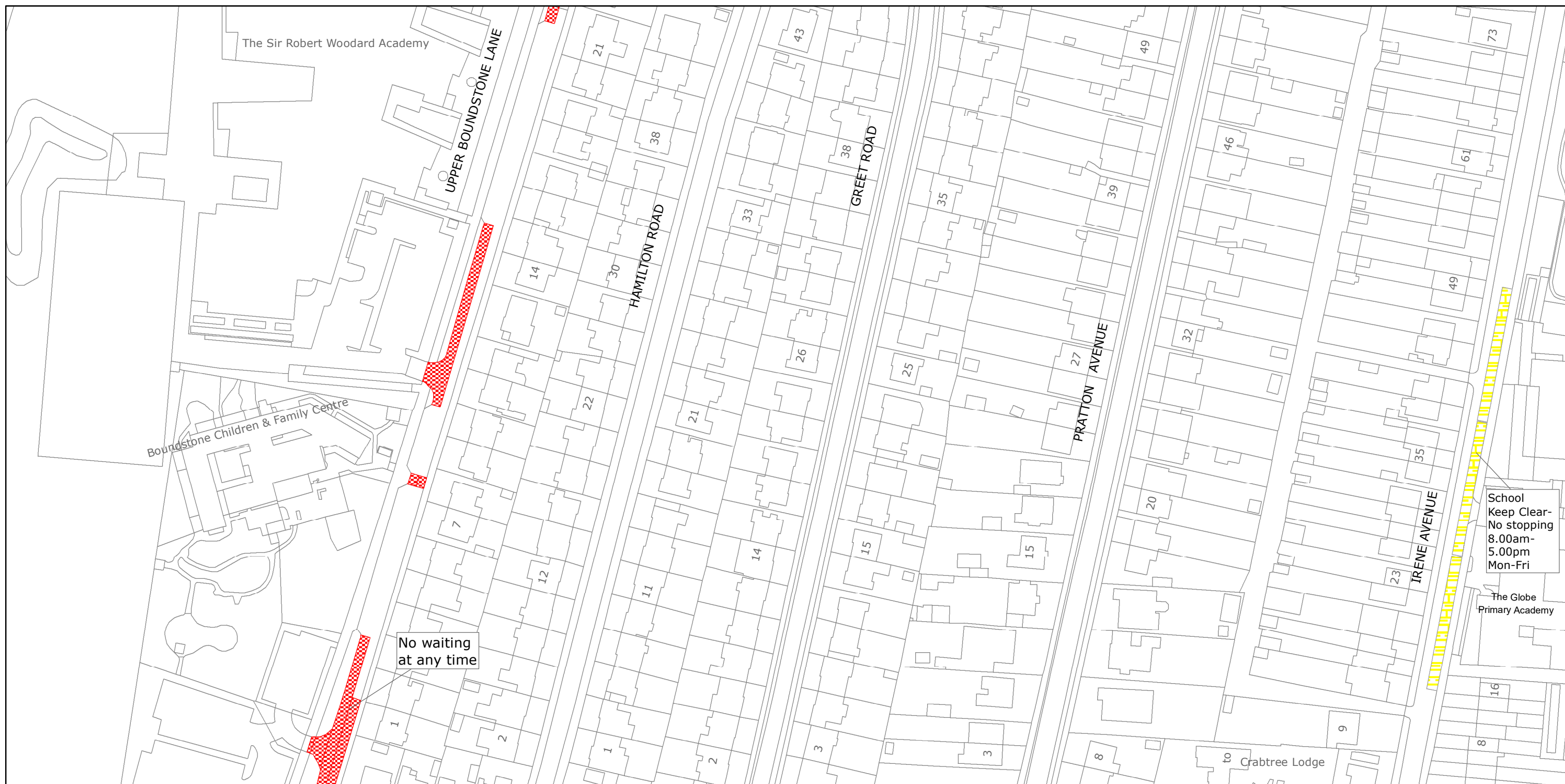

West Sussex County Council
Highways & Transport
The Grange
Tower Street
Chichester
West Sussex
PO19 1RH

ADUR DISTRICT: LANCING AND SOMPTING
WAITING RESTRICTIONS

Reproduced from or based upon 2020 Ordnance Survey mapping with permission of the Controller of HMSO (c) Crown Copyright reserved.
Unauthorised reproduction infringes Crown copyright and may lead to prosecution or civil proceedings West Sussex County Council Licence No. 100018485

TILE REF NO:
TQ1705SES

SHEET ISSUE NO 2
SHEET ACTIVE FROM - 12/03/2020



SCALE:
1:1250
at A3 size

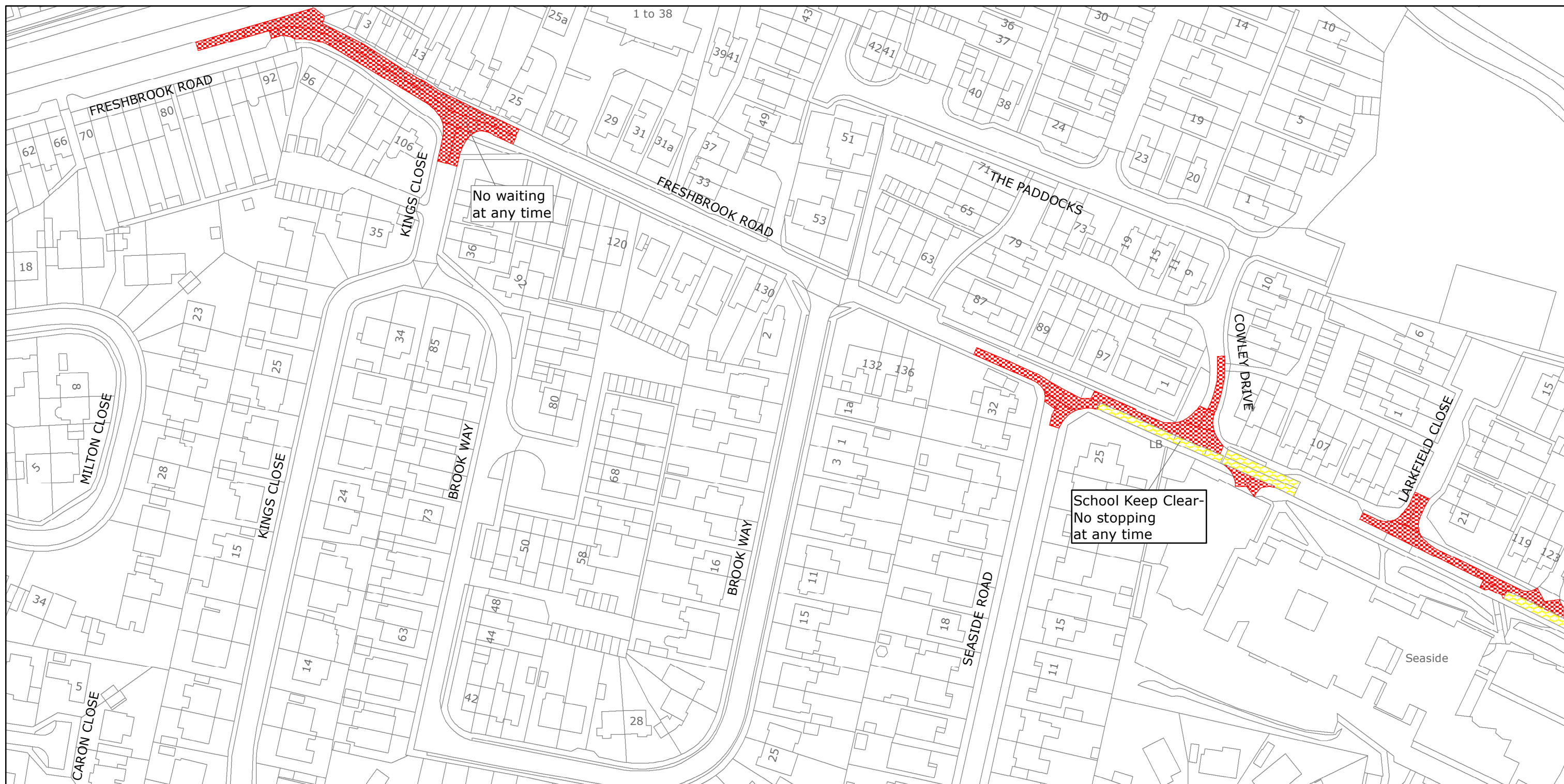

West Sussex County Council
Highways & Transport
The Grange
Tower Street
Chichester
West Sussex
PO19 1RH

ADUR DISTRICT: LANCING
WAITING RESTRICTIONS

Reproduced from or based upon 2020 Ordnance Survey mapping with permission of the Controller of HMSO (c) Crown Copyright reserved.
Unauthorised reproduction infringes Crown copyright and may lead to prosecution or civil proceedings West Sussex County Council Licence No. 100018485

TILE REF NO:
TQ1804SEN

SHEET ISSUE NO 4
SHEET ACTIVE FROM - 12/03/2020



SCALE:
1:1250
at A3 size



West Sussex County Council
Highways & Transport
The Grange
Tower Street
Chichester
West Sussex
PO19 1RH

ADUR DISTRICT: LANCING
WAITING RESTRICTIONS

Reproduced from or based upon 2020 Ordnance Survey mapping with permission of the Controller of HMSO (c) Crown Copyright reserved.
Unauthorised reproduction infringes Crown copyright and may lead to prosecution or civil proceedings West Sussex County Council Licence No. 100018485

TILE REF NO:
TQ1804SES

SHEET ISSUE NO 3
SHEET ACTIVE FROM - 12/03/2020



SCALE:
1:1250
at A3 size

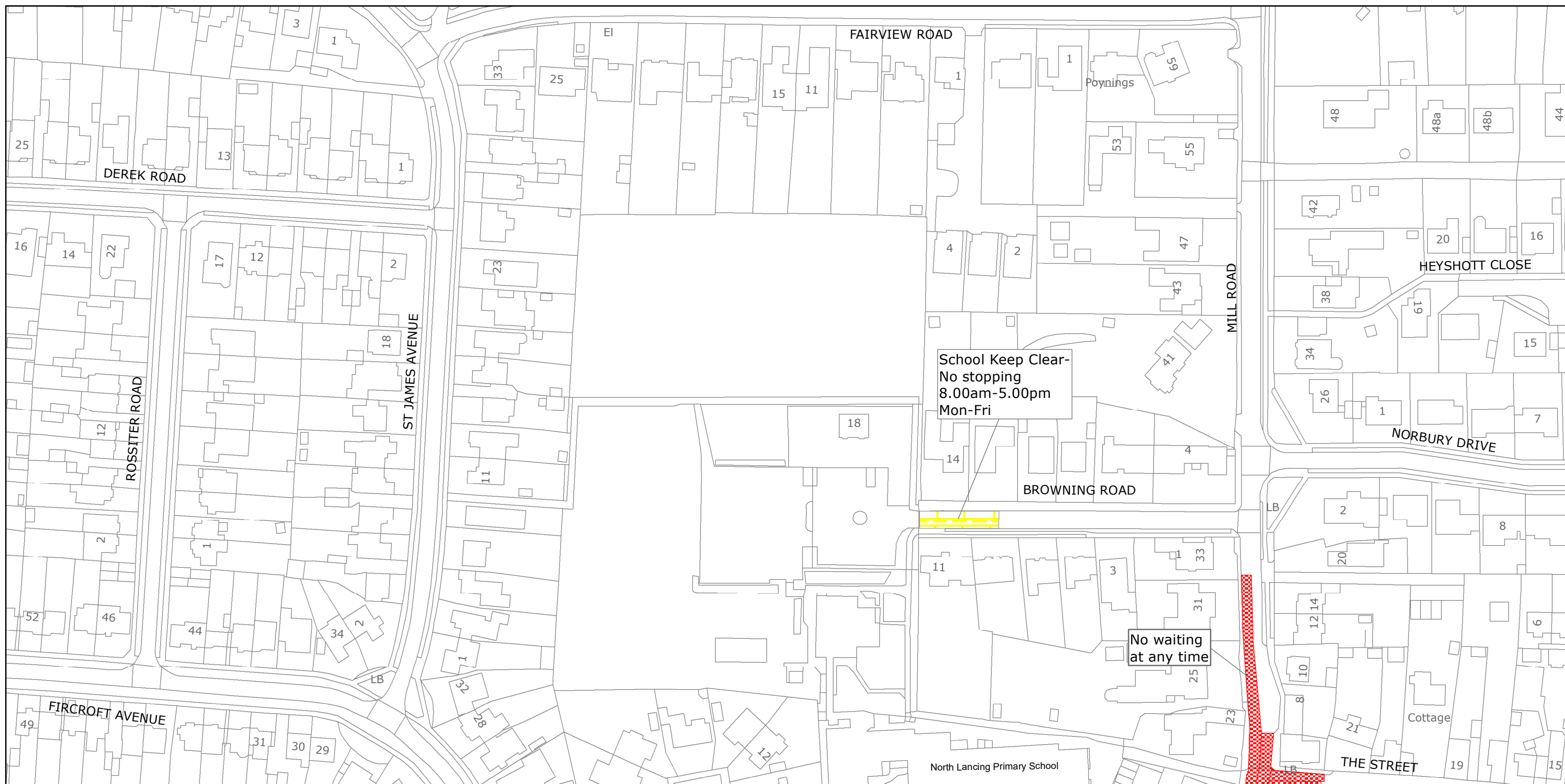

West Sussex County Council
Highways & Transport
The Grange
Tower Street
Chichester
West Sussex
PO19 1RH

ADUR DISTRICT: LANCING
WAITING RESTRICTIONS

Reproduced from or based upon 2020 Ordnance Survey mapping with permission of the Controller of HMSO (c) Crown Copyright reserved.
Unauthorised reproduction infringes Crown copyright and may lead to prosecution or civil proceedings West Sussex County Council Licence No. 100018485

TILE REF NO:
TQ1805NWN

SHEET ISSUE NO 2
SHEET ACTIVE FROM - 12/03/2020



SCALE:
1:1250
at A3 size



West Sussex County Council
Highways & Transport
The Grange
Tower Street
Chichester
West Sussex
PO19 1RH

ADUR DISTRICT: LANCING
WAITING RESTRICTIONS

Reproduced from or based upon 2020 Ordnance Survey mapping with permission of the Controller of HMSO (c) Crown Copyright reserved.
Unauthorised reproduction infringes Crown copyright and may lead to prosecution or civil proceedings West Sussex County Council Licence No. 100018485

TILE REF NO:
TQ1805SWS

SHEET ISSUE NO 1
SHEET ACTIVE FROM - 12/03/2020



SCALE:
1:1250
at A3 size



School
Keep Clear-
No stopping
at any time

No waiting
at any time



West Sussex County Council
Highways & Transport
The Grange
Tower Street
Chichester
West Sussex
PO19 1RH

ADUR DISTRICT: LANCING
WAITING RESTRICTIONS

Reproduced from or based upon 2020 Ordnance Survey mapping with permission of the Controller of HMSO (c) Crown Copyright reserved.
Unauthorised reproduction infringes Crown copyright and may lead to prosecution or civil proceedings West Sussex County Council Licence No. 100018485

TILE REF NO:
TQ1904SWN

SHEET ISSUE NO 3
SHEET ACTIVE FROM - 12/03/2020



SCALE:
1:1250
at A3 size



West Sussex County Council
Highways & Transport
The Grange
Tower Street
Chichester
West Sussex
PO19 1RH

ADUR DISTRICT: LANCING
WAITING RESTRICTIONS

Reproduced from or based upon 2020 Ordnance Survey mapping with permission of the Controller of HMSO (c) Crown Copyright reserved.
Unauthorised reproduction infringes Crown copyright and may lead to prosecution or civil proceedings West Sussex County Council Licence No. 100018485

TILE REF NO:
TQ1904SWS

SHEET ISSUE NO 3
SHEET ACTIVE FROM - 12/03/2020



SCALE:
1:1250
at A3 size

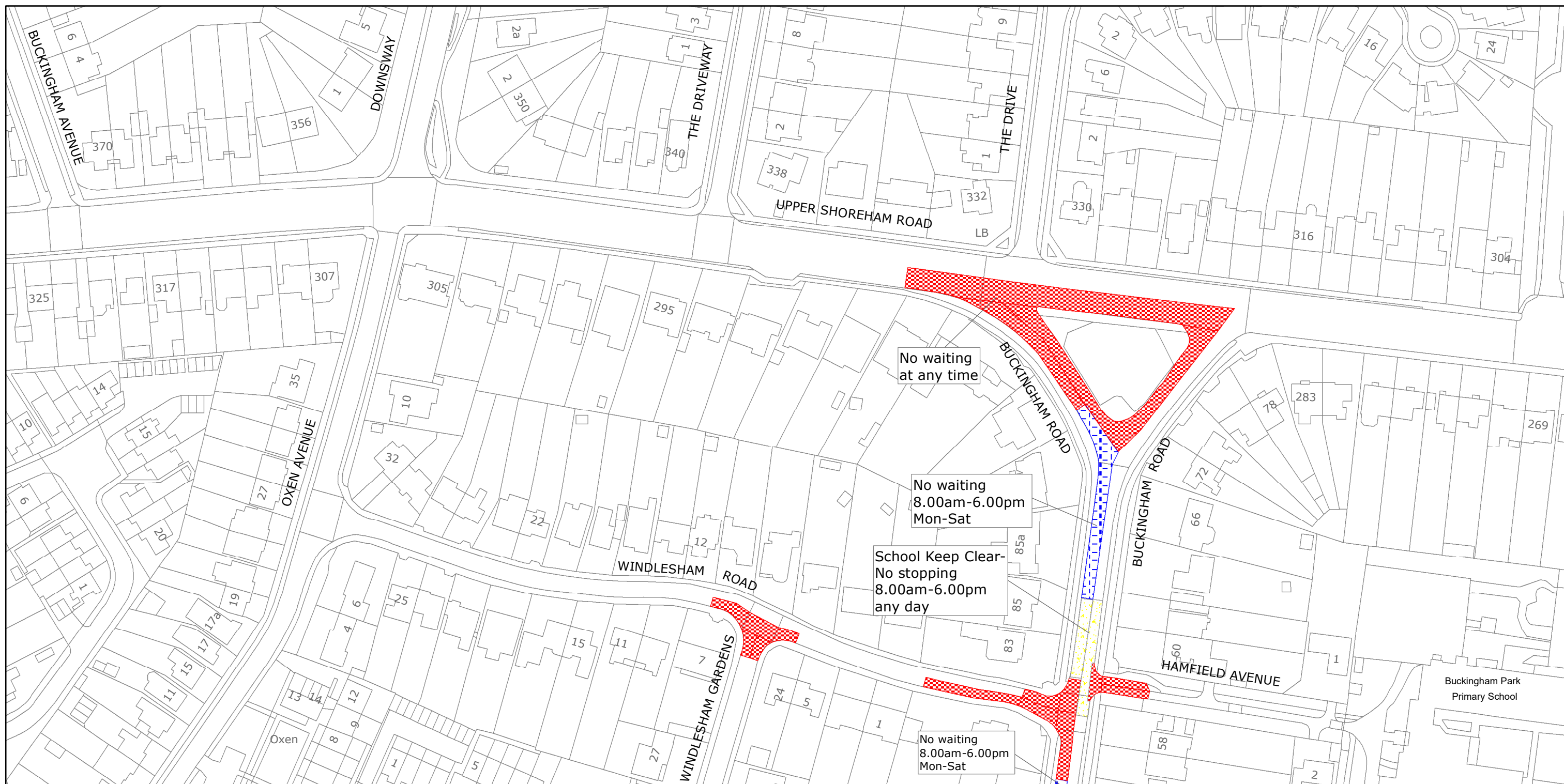

West Sussex County Council
Highways & Transport
The Grange
Tower Street
Chichester
West Sussex
PO19 1RH

ADUR DISTRICT: SHOREHAM/SOUTHWICK

WAITING RESTRICTIONS

Reproduced from or based upon 2020 Ordnance Survey mapping with permission of the Controller of HMSO (c) Crown Copyright reserved.
Unauthorised reproduction infringes Crown copyright and may lead to prosecution or civil proceedings West Sussex County Council Licence No. 100018485

TILE REF NO: TQ2105NEN

SHEET ISSUE NO 3
SHEET ACTIVE FROM - 12/03/2020



SCALE:
1:1250
at A3 size

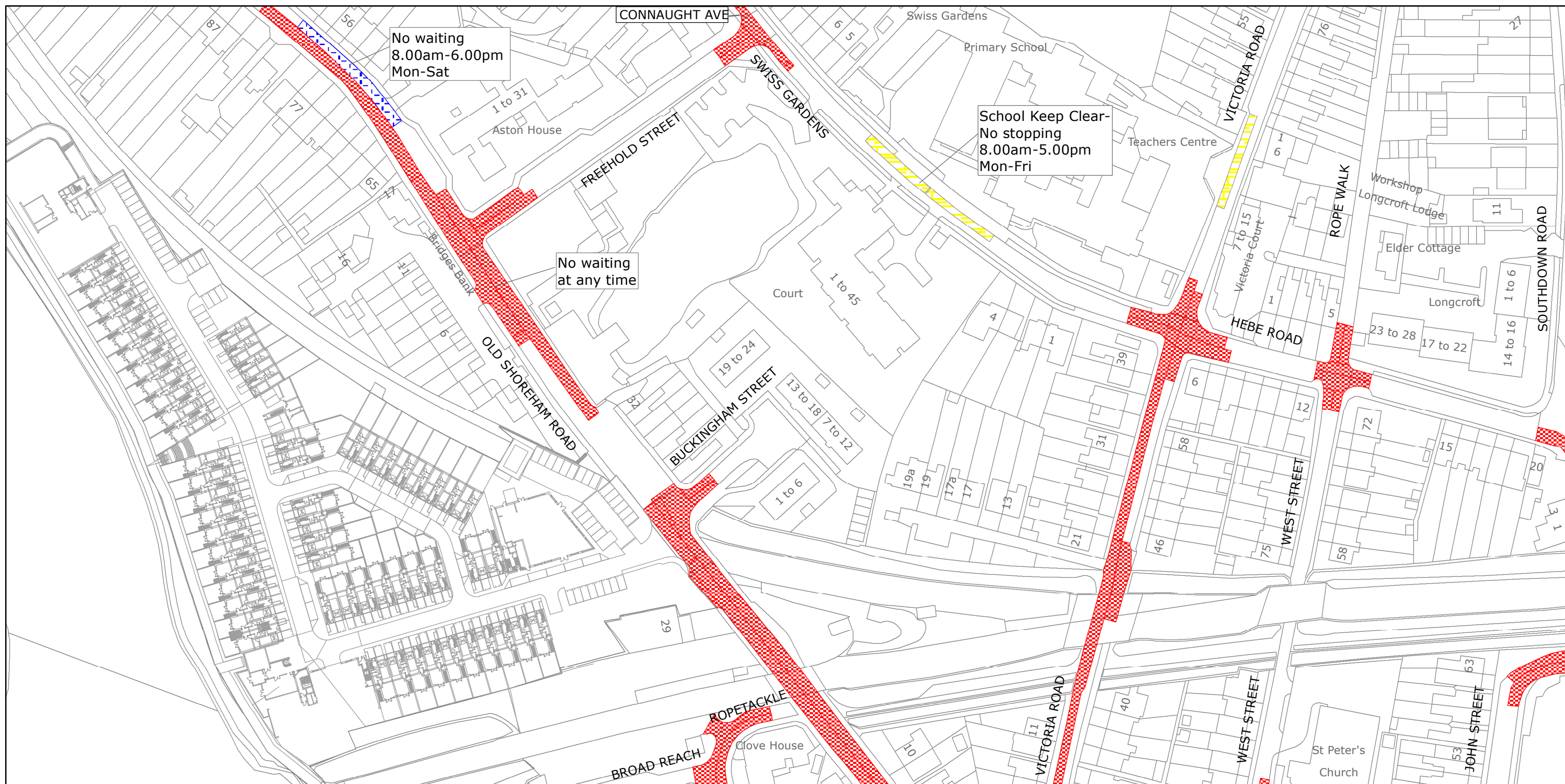

West Sussex County Council
Highways & Transport
The Grange
Tower Street
Chichester
West Sussex
PO19 1RH

ADUR DISTRICT: SHOREHAM/SOUTHWICK
WAITING RESTRICTIONS

Reproduced from or based upon 2020 Ordnance Survey mapping with permission of the Controller of HMSO (c) Crown Copyright reserved.
Unauthorised reproduction infringes Crown copyright and may lead to prosecution or civil proceedings West Sussex County Council Licence No. 100018485

TILE REF NO:
TQ2105SWN

SHEET ISSUE NO 5
SHEET ACTIVE FROM - 12/03/2020



SCALE:
1:1250
at A3 size

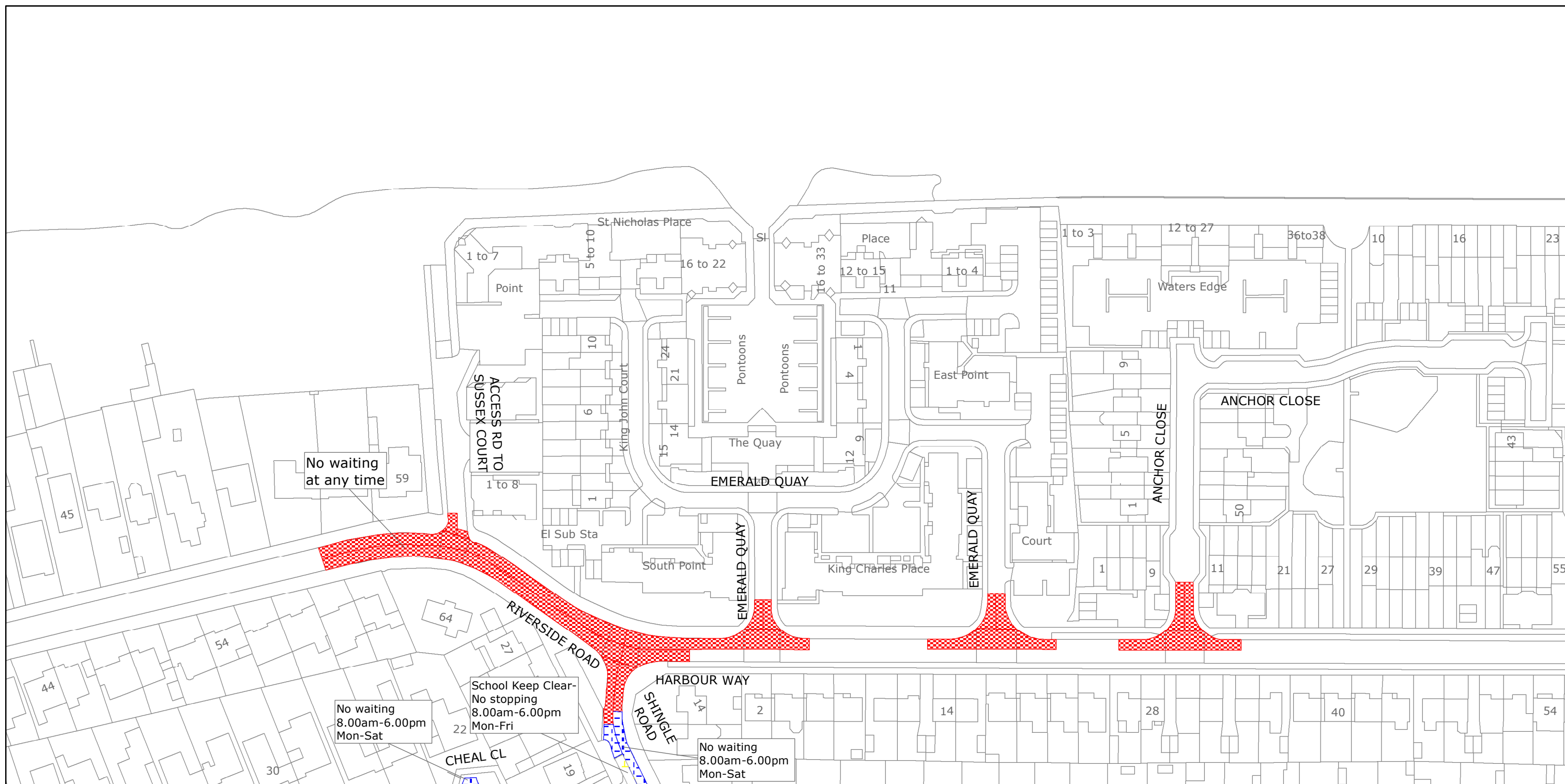

West Sussex County Council
Highways & Transport
The Grange
Tower Street
Chichester
West Sussex
PO19 1RH

ADUR DISTRICT: SHOREHAM/SOUTHWICK
WAITING RESTRICTIONS

Reproduced from or based upon 2020 Ordnance Survey mapping with permission of the Controller of HMSO (c) Crown Copyright reserved.
Unauthorised reproduction infringes Crown copyright and may lead to prosecution or civil proceedings West Sussex County Council Licence No. 100018485

TILE REF NO:
TQ2204NWN

SHEET ISSUE NO 2
SHEET ACTIVE FROM - 12/03/2020



SCALE:
1:1250
at A3 size

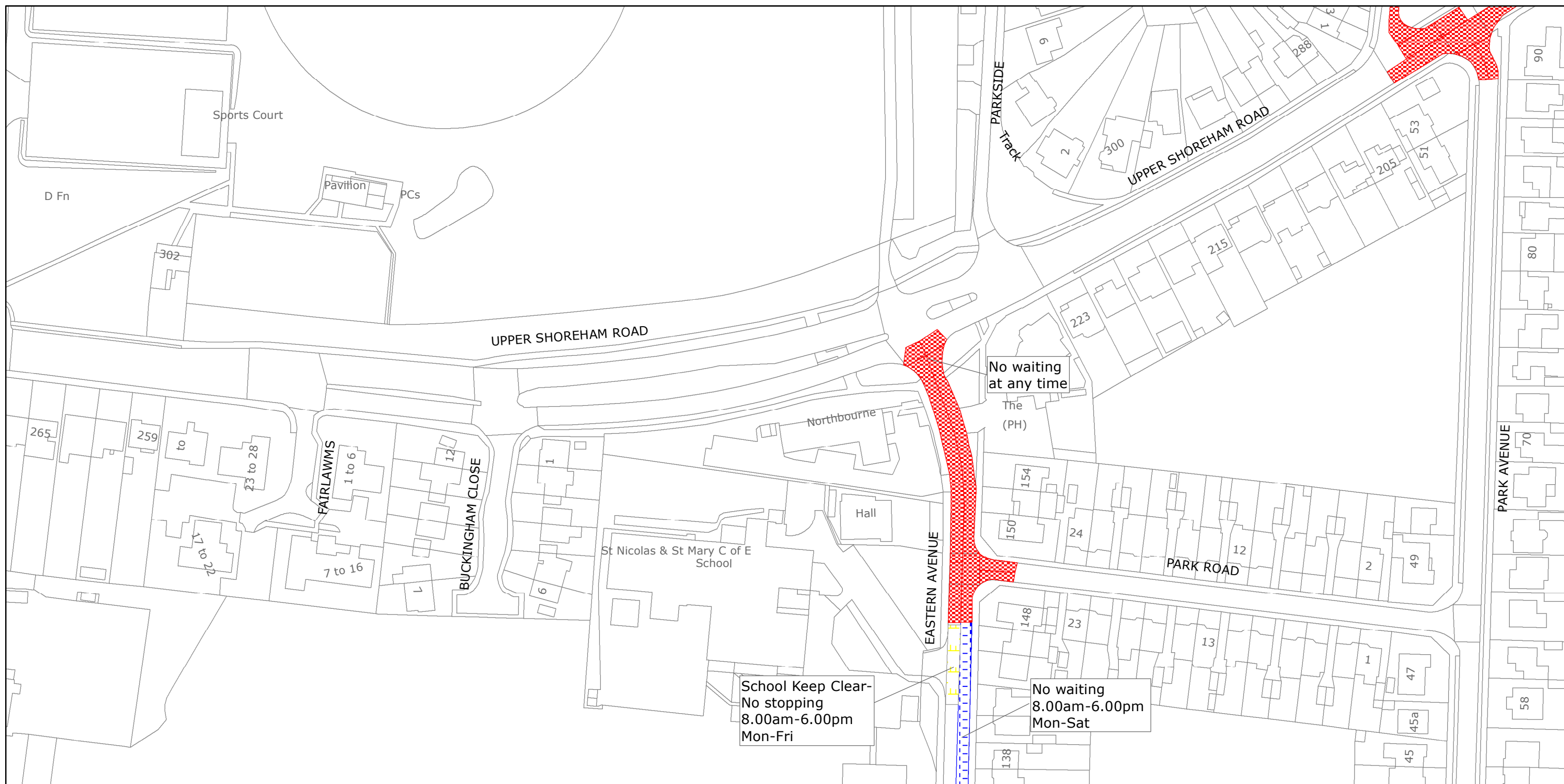

West Sussex County Council
Highways & Transport
The Grange
Tower Street
Chichester
West Sussex
PO19 1RH

ADUR DISTRICT: SHOREHAM/SOUTHWICK

WAITING RESTRICTIONS

Reproduced from or based upon 2020 Ordnance Survey mapping with permission of the Controller of HMSO (c) Crown Copyright reserved.
Unauthorised reproduction infringes Crown copyright and may lead to prosecution or civil proceedings West Sussex County Council Licence No. 100018485

TILE REF NO: TQ2205NWN

SHEET ISSUE NO 3
SHEET ACTIVE FROM - 12/03/2020



SCALE:
1:1250
at A3 size

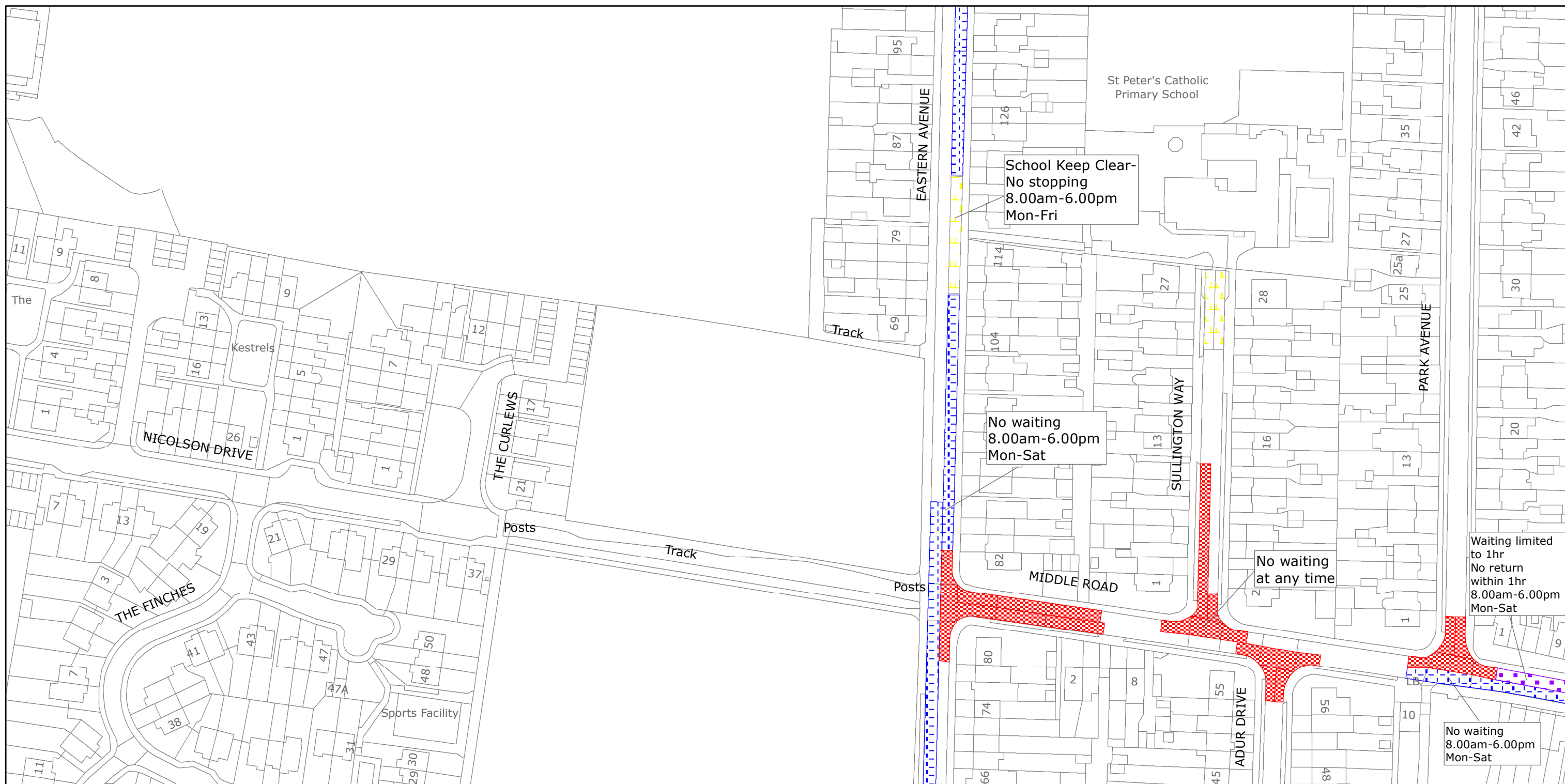

West Sussex County Council
Highways & Transport
The Grange
Tower Street
Chichester
West Sussex
PO19 1RH

ADUR DISTRICT: SHOREHAM/SOUTHWICK
WAITING RESTRICTIONS

Reproduced from or based upon 2020 Ordnance Survey mapping with permission of the Controller of HMSO (c) Crown Copyright reserved.
Unauthorised reproduction infringes Crown copyright and may lead to prosecution or civil proceedings West Sussex County Council Licence No. 100018485

TILE REF NO:
TQ2205NWS

SHEET ISSUE NO 4
SHEET ACTIVE FROM - 12/03/2020



SCALE:
1:1250
at A3 size

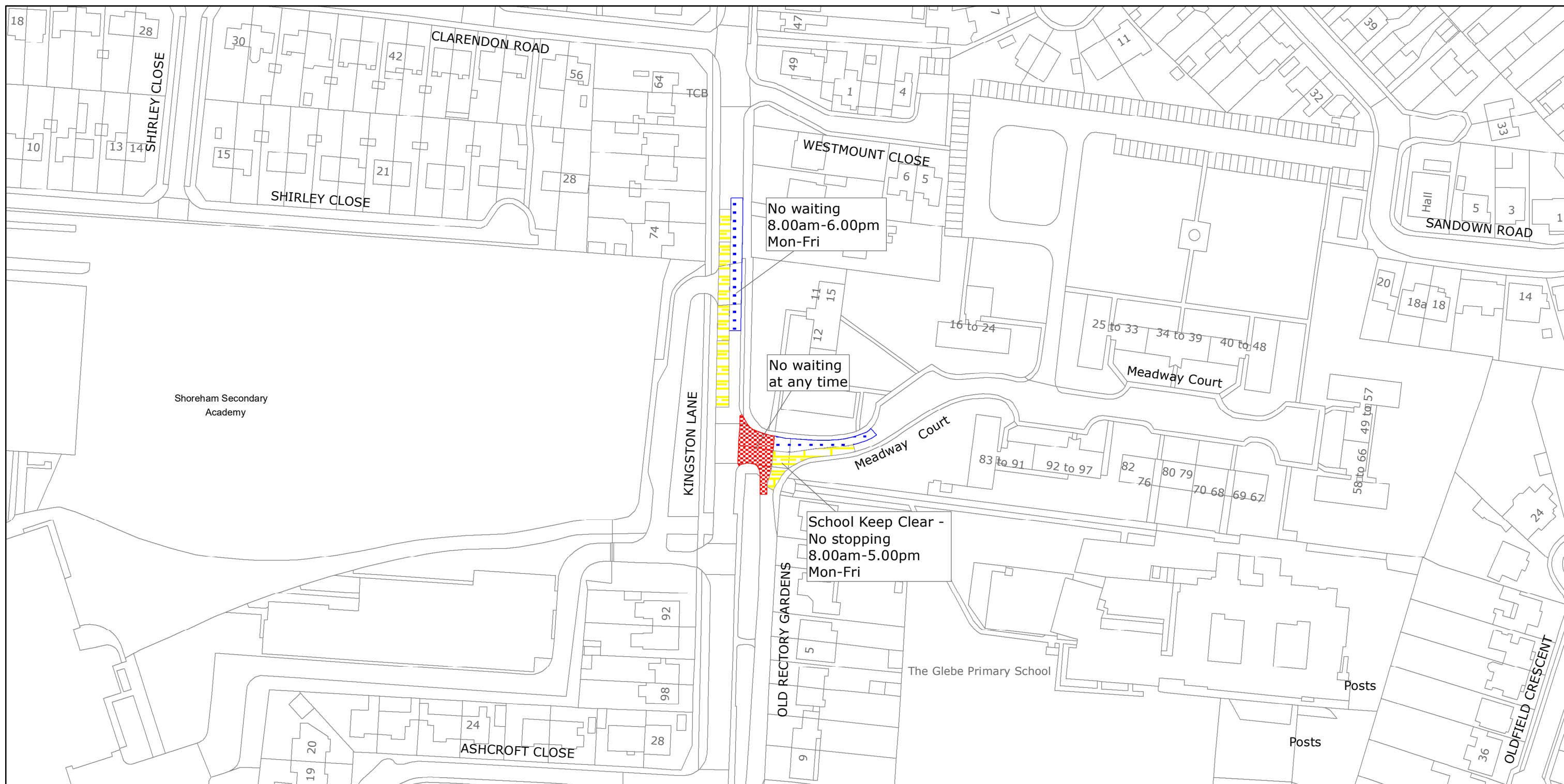

West Sussex County Council
Highways & Transport
The Grange
Tower Street
Chichester
West Sussex
PO19 1RH

ADUR DISTRICT: SHOREHAM/SOUTHWICK
WAITING RESTRICTIONS

Reproduced from or based upon 2020 Ordnance Survey mapping with permission of the Controller of HMSO (c) Crown Copyright reserved.
Unauthorised reproduction infringes Crown copyright and may lead to prosecution or civil proceedings West Sussex County Council Licence No. 100018485

TILE REF NO:
TQ2305NES

SHEET ISSUE NO 2
SHEET ACTIVE FROM - 12/03/2020



SCALE:
1:1250
at A3 size



West Sussex County Council
Highways & Transport
The Grange
Tower Street
Chichester
West Sussex
PO19 1RH

ADUR DISTRICT: SHOREHAM/SOUTHWICK
WAITING RESTRICTIONS

Reproduced from or based upon 2020 Ordnance Survey mapping with permission of the Controller of HMSO (c) Crown Copyright reserved.
Unauthorised reproduction infringes Crown copyright and may lead to prosecution or civil proceedings West Sussex County Council Licence No. 100018485

TILE REF NO:
TQ2305NWS

SHEET ISSUE NO 3
SHEET ACTIVE FROM - 12/03/2020



SCALE:
1:1250
at A3 size

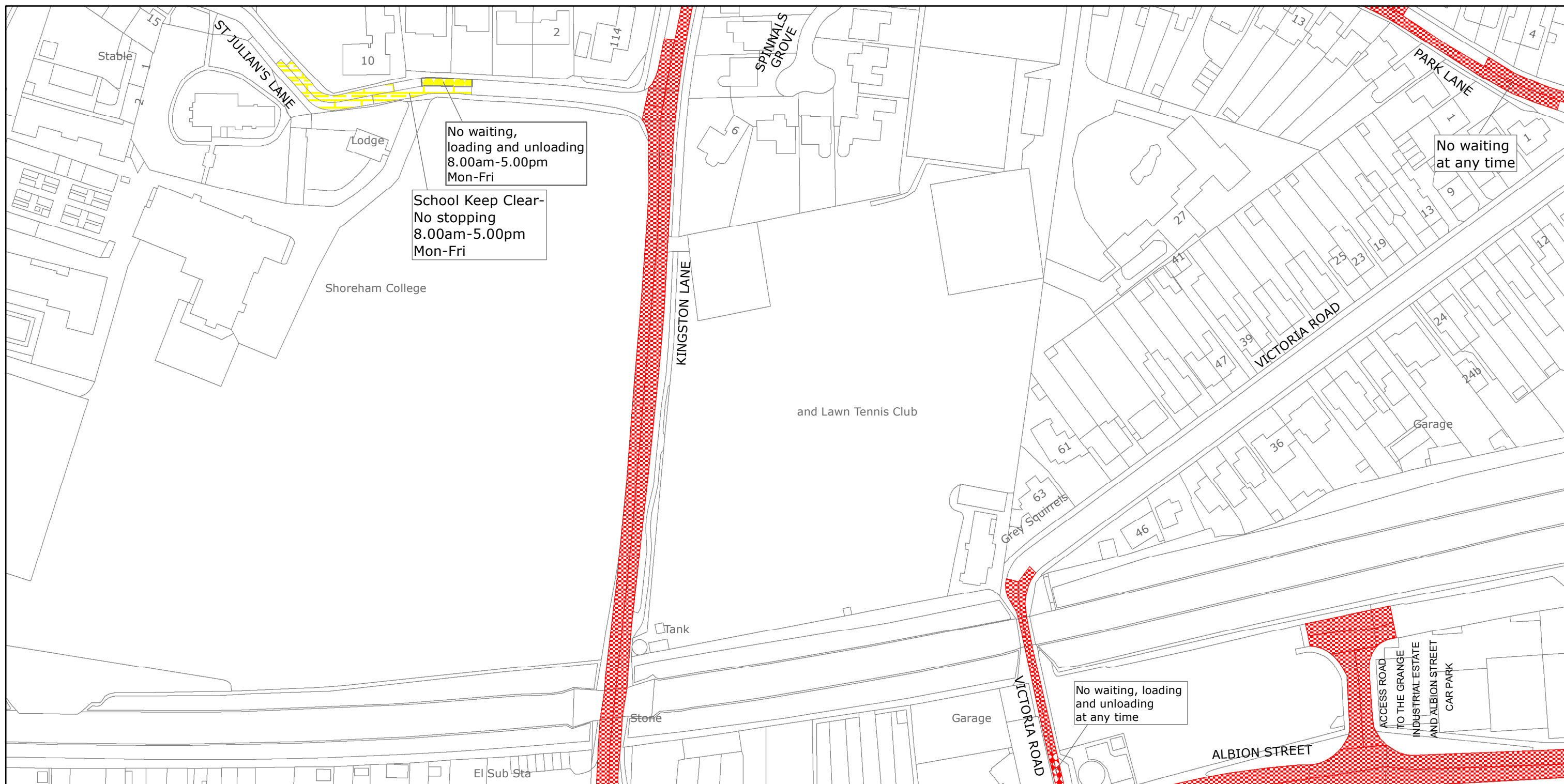

West Sussex County Council
Highways & Transport
The Grange
Tower Street
Chichester
West Sussex
PO19 1RH

ADUR DISTRICT: SHOREHAM/SOUTHWICK
WAITING RESTRICTIONS

Reproduced from or based upon 2020 Ordnance Survey mapping with permission of the Controller of HMSO (c) Crown Copyright reserved.
Unauthorised reproduction infringes Crown copyright and may lead to prosecution or civil proceedings West Sussex County Council Licence No. 100018485

TILE REF NO:
TQ2305SES

SHEET ISSUE NO 3
SHEET ACTIVE FROM - 12/03/2020



SCALE:
1:1250
at A3 size

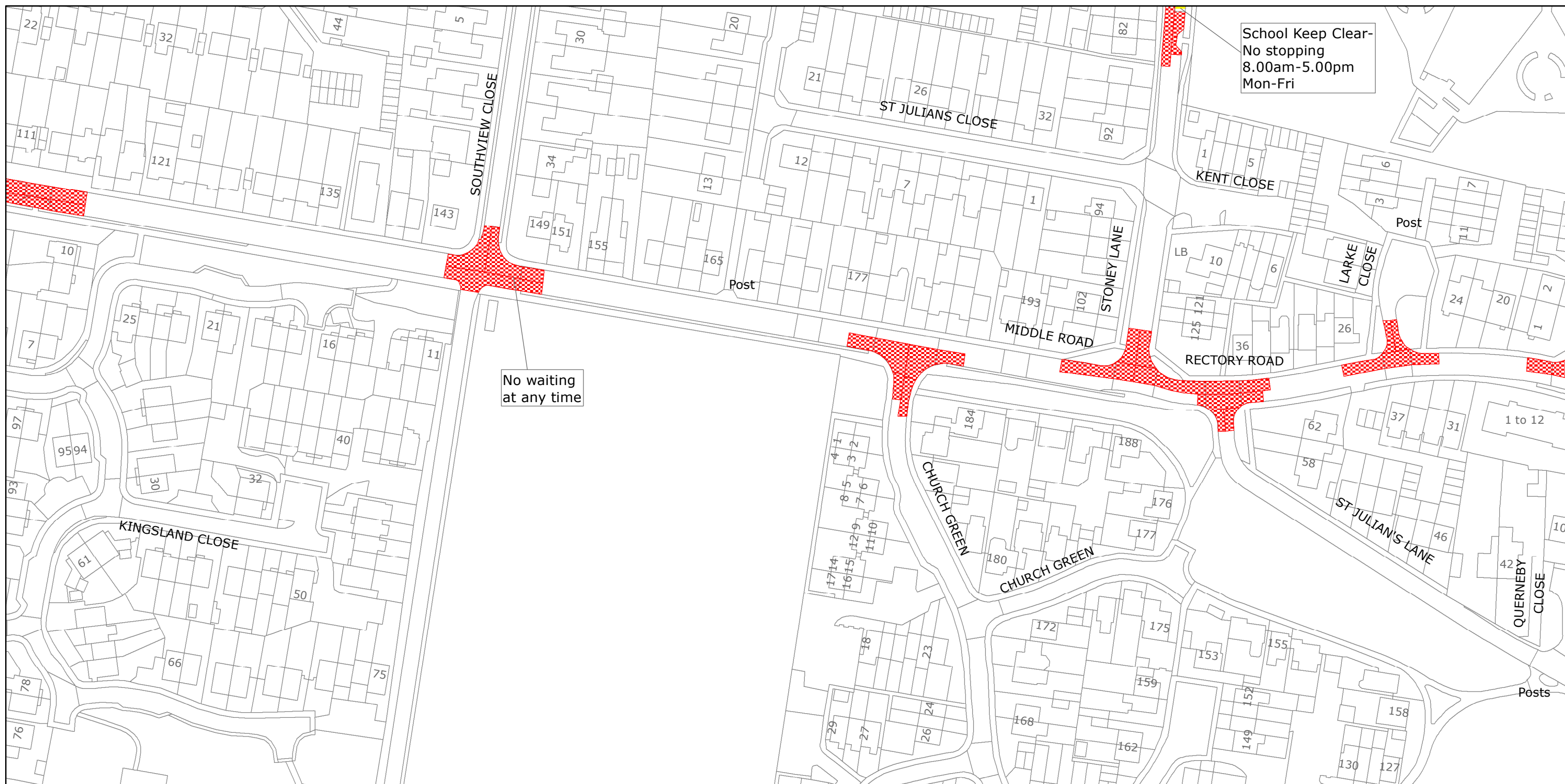

West Sussex County Council
Highways & Transport
The Grange
Tower Street
Chichester
West Sussex
PO19 1RH

ADUR DISTRICT: SHOREHAM/SOUTHWICK
WAITING RESTRICTIONS

Reproduced from or based upon 2020 Ordnance Survey mapping with permission of the Controller of HMSO (c) Crown Copyright reserved.
Unauthorised reproduction infringes Crown copyright and may lead to prosecution or civil proceedings West Sussex County Council Licence No. 100018485

TILE REF NO:
TQ2305SWN

SHEET ISSUE NO 3
SHEET ACTIVE FROM - 12/03/2020



SCALE:
1:1250
at A3 size



School Keep Clear-
No stopping
8.00am-5.00pm
Mon-Fri



West Sussex County Council
Highways & Transport
The Grange
Tower Street
Chichester
West Sussex
PO19 1RH

ADUR DISTRICT: SHOREHAM/SOUTHWICK
WAITING RESTRICTIONS

Reproduced from or based upon 2020 Ordnance Survey mapping with permission of the Controller of HMSO (c) Crown Copyright reserved.
Unauthorised reproduction infringes Crown copyright and may lead to prosecution or civil proceedings West Sussex County Council Licence No. 100018485

TILE REF NO:
TQ2306SEN

SHEET ISSUE NO 1
SHEET ACTIVE FROM - 12/03/2020



SCALE:
1:1250
at A3 size

